



UNIT PLANS

1.5 Bedroom homes

85.03 Sq.m (915 Sq.ft.) - 91.97 Sq.m (990 Sq.ft.)



1.5
Bedroom
Homes





**1.5
Bedroom
Homes**



The information depicted herein viz., master plans, floor plans, furniture layout, fittings, illustrations, specifications, designs, dimensions, rendered views, colours, amenities and facilities etc., are subject to change without notifications as may be required by the relevant authorities or the developer's architect, and cannot form part of an offer or contract. Whilst every care is taken in providing this information, the Developer cannot be held liable for variations. All illustrations and pictures are artist's impression only. The information are subject to variations, additions, deletions, substitutions and modifications as may be recommended by the company's architect and/or the relevant approving authorities. The Developer is wholly exempt from any liability on account of any claim in this regard.

1.5 BHK UNIT (1 Bedroom + 1 Study + 1 Toilet)



KEY PLAN

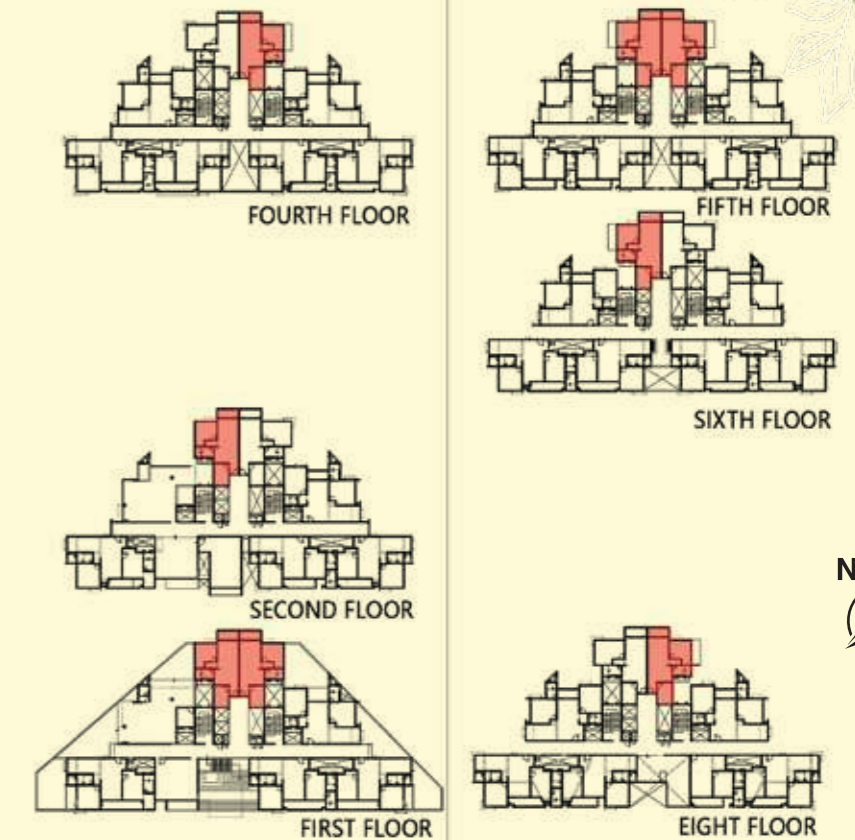

SUPER BUILT-UP AREA

85.03 Sq.m (915 Sq.ft.)

UNIT CARPET AREA

49.12 Sq.m (528.72 Sq.ft.)

BALCONY CARPET AREA

3.93 sq.m (42.30 Sq.ft.)

The information depicted herein viz., master plans, floor plans, furniture layout, fittings, illustrations, specifications, designs, dimensions, rendered views, colours, amenities and facilities etc., are subject to change without notifications as may be required by the relevant authorities or the developer's architect, and cannot form part of an offer or contract. Whilst every care is taken in providing this information, the Developer cannot be held liable for variations. All illustrations and pictures are artist's impression only. The information are subject to variations, additions, deletions, substitutions and modifications as may be recommended by the company's architect and/or the relevant approving authorities. The Developer is wholly exempt from any liability on account of any claim in this regard. (1 square metre = 10.764 square feet). E & OE. All dimensions and calculations are done in metric system (M/Sq.m), and imperial system (Ft/Sq.ft) shown is for reference only. All dimensions indicated in the drawing are from unfinished surfaces, excluding plaster thickness and tile thickness.

Goldspire
at
BRIGADE
ORCHARDS

1.5 BHK UNIT (1 Bedroom + 1 Study + 1 Toilet)

KEY PLAN



THIRD FLOOR



SUPER BUILT-UP AREA

85.33 Sq.m (918 Sq.ft.)

UNIT CARPET AREA

49.50 Sq.m (532.81 Sq.ft.)

BALCONY CARPET AREA

3.97 sq.m (42.73 Sq.ft.)

The information depicted herein viz., master plans, floor plans, furniture layout, fittings, illustrations, specifications, designs, dimensions, rendered views, colours, amenities and facilities etc., are subject to change without notifications as may be required by the relevant authorities or the developer's architect, and cannot form part of an offer or contract. Whilst every care is taken in providing this information, the Developer cannot be held liable for variations. All illustrations and pictures are artist's impression only. The information are subject to variations, additions, deletions, substitutions and modifications as may be recommended by the company's architect and/or the relevant approving authorities. The Developer is wholly exempt from any liability on account of any claim in this regard. (1 square metre = 10.764 square feet). E & OE. All dimensions and calculations are done in metric system (M/Sq.m), and imperial system (Ft/Sq.ft) shown is for reference only. All dimensions indicated in the drawing are from unfinished surfaces, excluding plaster thickness and tile thickness.

Goldspire
at
BRIGADE
ORCHARDS

1.5 BHK UNIT (1 Bedroom + 1 Study + 1 Toilet)



KEY PLAN

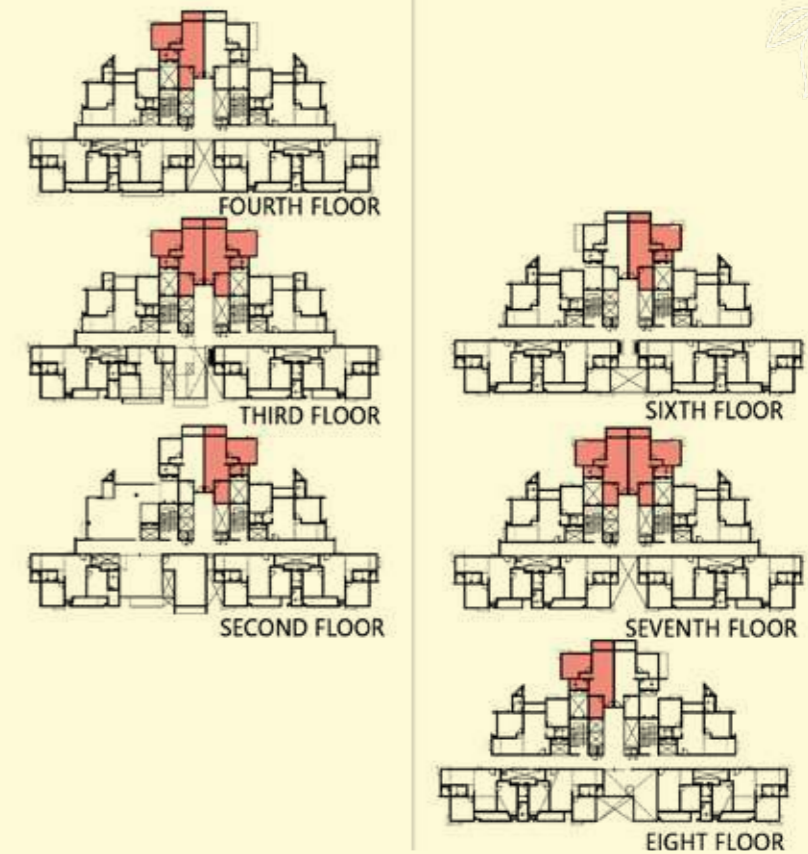

SUPER BUILT-UP AREA

91.97 Sq.m (990 Sq.ft.)

UNIT CARPET AREA

53.50 Sq.m (575.87 Sq.ft.)

BALCONY CARPET AREA

3.93 sq.m (42.30 Sq.ft.)

The information depicted herein viz., master plans, floor plans, furniture layout, fittings, illustrations, specifications, designs, dimensions, rendered views, colours, amenities and facilities etc., are subject to change without notifications as may be required by the relevant authorities or the developer's architect, and cannot form part of an offer or contract. Whilst every care is taken in providing this information, the Developer cannot be held liable for variations. All illustrations and pictures are artist's impression only. The information are subject to variations, additions, deletions, substitutions and modifications as may be recommended by the company's architect and/or the relevant approving authorities. The Developer is wholly exempt from any liability on account of any claim in this regard. (1 square metre = 10.764 square feet). E & OE. All dimensions and calculations are done in metric system (M/Sq.m), and imperial system (Ft/Sq.ft) shown is for reference only. All dimensions indicated in the drawing are from unfinished surfaces, excluding plaster thickness and tile thickness.

Goldspire
at
BRIGADE
ORCHARDS